



Chester Road, Brownhills
Walsall, WS8 6DP

£220,000

Brownhills

£220,000



Paul Carr Estate Agents are pleased to offer for sale this well presented three-bedroom end terrace home with driveway to front for two cars and open countryside views to the rear.

The property briefly comprises hallway, spacious lounge, re-fitted dining kitchen, utility, re-fitted ground floor bathroom, three good sized bedrooms and large rear garden which has a decked patio and far reaching views towards Lichfield.

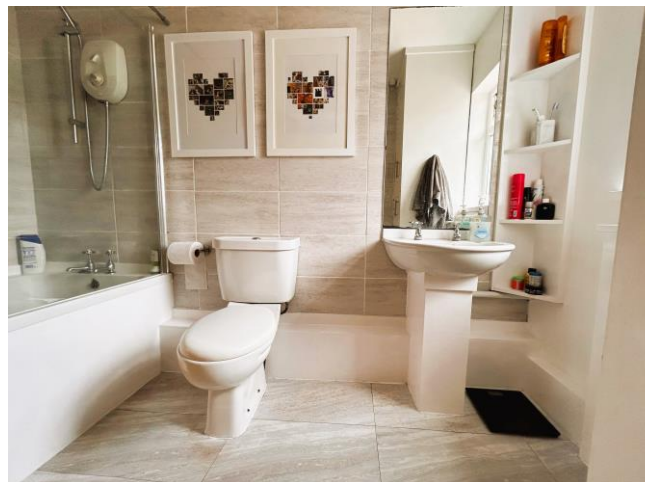



Property Specification

THREE DOUBLE BEDROOMS
OPEN VIEWS TOWARDS LICHFIELD TO REAR
LOUNGE WITH BAY WINDOW
FITTED KITCHEN
UTILITY ROOM

Entrance Hall

Lounge/Diner 16' 7" x 12' 10" (5.05m x 3.91m)

Kitchen/Breakfast Room 10' 5" x 9' 6" (3.17m x 2.89m)

Utility room 7' 8" x 5' 4" (2.34m x 1.62m)

Ground Floor Bathroom 9' 8" x 5' 2" (2.94m x 1.57m)

Bedroom One 16' 3" x 11' 3" (4.95m x 3.43m)

Bedroom Two 13' 4" x 8' 2" (4.06m x 2.49m)

Bedroom Three 9' 9" x 7' 9" (2.97m x 2.36m)

Agent's Note:

Every care has been taken with the preparation of these Sales Particulars but they are for general guidance only and complete accuracy cannot be guaranteed. If there is any point which is of particular importance, professional verification should be sought. The mention of any fixtures, fittings and/or appliances does not imply they are in full efficient working order as they have not been tested. All dimensions are approximate. Photographs are reproduced for general information and it cannot be inferred that any item shown is included in the sale. These Sales Particulars do not constitute a contract or part of a contract.
Came on the market: 22nd May 2024

Viewer's Note:

Services connected: Mains gas, electricity, water & drainage
Council tax band: B
Tenure: Freehold

Floor Plan

This floor plan is not drawn to scale and is for illustration purposes only

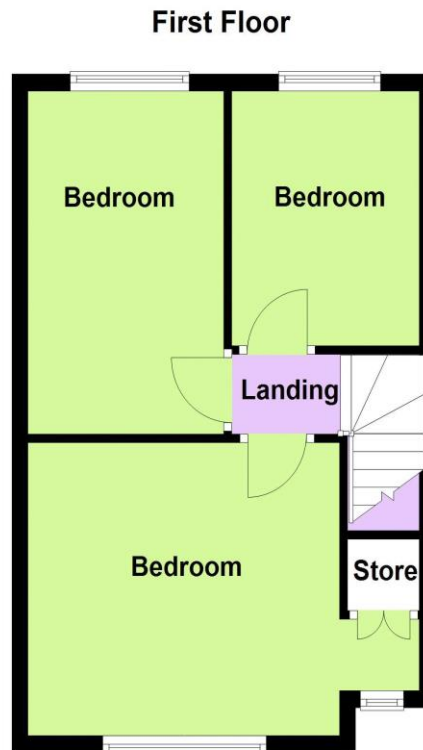
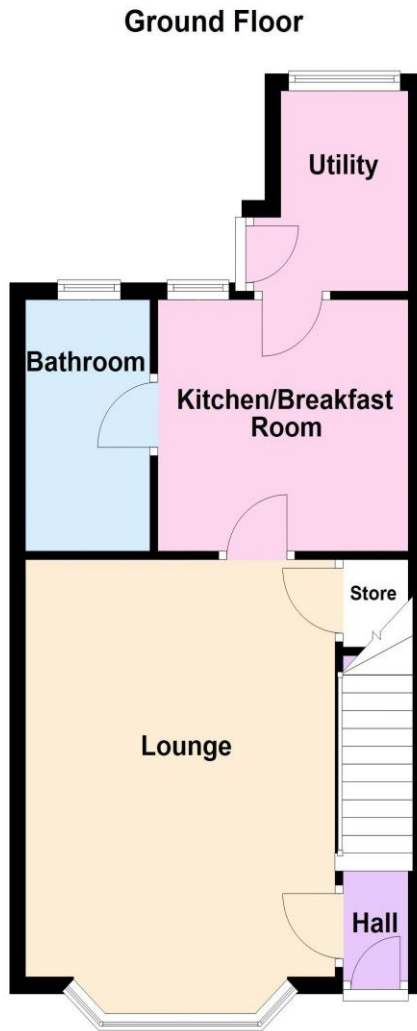

Energy Efficiency Rating

Score	Energy rating	Current	Potential
92+	A		
81-91	B		85 B
69-80	C		
55-68	D	62 D	
39-54	E		
21-38	F		
1-20	G		

Map Location

